

Photograph of Products:

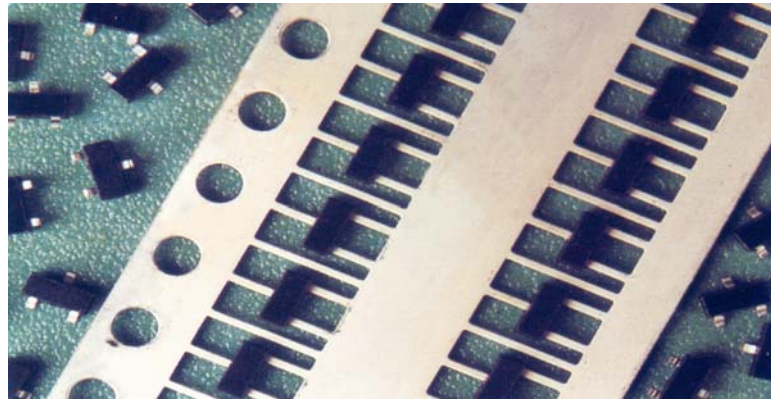

Performance and Characteristics:

● NPN Silicon General Purpose Power Transistors

Type	P _{tot} (mW)	I _c (mA)	V _{CEO} (V)	h _{FE}	Polar 123
2SC1623L3	225	100	40	60~90	BEC
2SC1623L4	225	100	40	90~135	BEC
2SC1623L5	225	100	40	135~200	BEC
2SC1623L6	225	100	40	200~400	BEC
2SC1623L7	225	100	40	400~600	BEC
2SC9013	225	500	20	100~250	BEC
2SC9014	225	100	20	100~800	BEC
BC817-16	225	500	45	100~250	BEC
BC817-25	225	500	45	160~400	BEC
BC817-40	225	500	45	250~600	BEC
BC818-16	225	500	25	100~250	BEC
BC818-25	225	500	25	160~400	BEC
BC818-40	225	500	25	250~600	BEC
BC846A	225	100	65	110~220	BEC
BC846B	225	100	65	200~450	BEC
BC847A	225	100	45	110~220	BEC
BC847B	225	100	45	200~450	BEC
BC847C	225	100	45	420~800	BEC
BC848A	225	100	30	110~220	BEC
BC848B	225	100	30	200~450	BEC
BC848C	225	100	30	420~800	BEC
BC849B	225	100	30	200~450	BEC
BC849C	225	100	30	420~800	BEC
BC850B	225	100	45	200~450	BEC
BC850C	225	100	45	420~800	BEC
BCW31	225	100	20	110~220	BEC
BCW33	225	100	20	420~800	BEC

Type	P _{tot} (mW)	I _c (mA)	V _{CEO} (V)	h _{FE}	Polar 123
BCW60A	225	100	32	120~220	BEC
BCW60B	225	100	32	175~310	BEC
BCW60C	225	100	32	250~460	BEC
BCW60D	225	100	32	380~630	BEC
BCW65A	225	800	32	100~250	BEC
BCW66H	225	800	45	100~250	BEC
BCW71	225	100	45	110~220	BEC
BCW72	225	100	45	200~450	BEC
BCX19	225	500	45	100~600	BEC
BCX20	225	500	25	100~600	BEC
BCX70G	225	200	45	120~220	BEC
BCX70H	225	200	45	180~310	BEC
BCX70J	225	200	45	250~460	BEC
BCX70K	225	200	45	380~630	BEC
BT2222	225	600	30	100~300	BEC
BT2222A	225	600	40	100~300	BEC
BT2484	225	50	60	250~800	BEC
BT3903	225	200	40	50~150	BEC
BT3904	225	200	40	100~300	BEC
BT4123	225	200	30	50~150	BEC
BT4401	225	600	40	100~300	BEC
BT5088	225	50	30	≥350	BEC
BT5089	225	50	25	≥450	BEC
BT8050B	225	800	25	85~160	BEC
BT8050C	225	800	25	120~200	BEC
BT8050D	225	800	25	160~300	BEC
BTA20	225	100	40	40~400	BEC



Type	P _{tot} (mW)	I _c (mA)	V _{CEO} (V)	h _{FE}	Polar 123	Type	P _{tot} (mW)	I _c (mA)	V _{CEO} (V)	h _{FE}	Polar 123
2SA9012	225	500	20	100~250	BEC	BCW30	225	100	32	215~500	BEC
2SA9015	225	100	20	100~800	BEC	BCW61A	225	100	32	120~220	BEC
2SA812M3	225	100	40	60~90	BEC	BCW61B	225	100	32	140~310	BEC
2SA812M4	225	100	40	90~135	BEC	BCW61C	225	100	32	250~460	BEC
2SA812M5	225	100	40	135~200	BEC	BCW61D	225	100	32	380~630	BEC
2SA812M6	225	100	40	200~400	BEC	BCW67	225	800	32	100~250	BEC
2SA812M7	225	100	40	400~600	BEC	BCW67A	225	800	32	100~250	BEC
BA812M3	225	100	40	60~120	BEC	BCW67B	225	800	32	160~400	BEC
BA812M4	225	100	40	90~180	BEC	BCW67C	225	800	32	250~630	BEC
BA812M5	225	100	40	135~270	BEC	BCW68	225	800	45	100~250	BEC
BA812M6	225	100	40	200~400	BEC	BCW68F	225	800	45	100~250	BEC
BA812M7	225	100	40	300~600	BEC	BCW68G	225	800	45	160~400	BEC
BC807-16	225	500	45	100~250	BEC	BCW69	225	100	45	120~260	BEC
BC807-25	225	500	45	160~400	BEC	BCW70	225	100	45	215~500	BEC
BC807-40	225	500	45	250~600	BEC	BCX17	225	500	45	100~600	BEC
BC808-16	225	500	25	100~250	BEC	BCX18	225	500	25	100~600	BEC
BC808-25	225	500	25	160~400	BEC	BCX71G	225	100	45	120~220	BEC
BC808-40	225	500	25	250~600	BEC	BCX71H	225	100	45	180~310	BEC
BC856A	225	100	65	125~250	BEC	BCX71J	225	100	45	250~460	BEC
BC856B	225	100	65	220~475	BEC	BCX71K	225	100	45	380~630	BEC
BC857A	225	100	45	125~250	BEC	BT2907	225	600	40	100~300	BEC
BC857B	225	100	45	220~475	BEC	BT2907A	225	600	60	100~300	BEC
BC857C	225	100	45	420~800	BEC	BT3906	225	200	40	100~300	BEC
BC858A	225	100	30	125~250	BEC	BT404	225	150	24	30~400	BEC
BC858B	225	100	30	220~475	BEC	BT404A	225	150	35	30~400	BEC
BC858C	225	100	30	420~800	BEC	BT4125	225	200	30	50~150	BEC
BC859A	225	100	30	110~220	BEC	BT4403	225	600	40	100~300	BEC
BC859B	225	100	30	200~450	BEC	BT5086	225	50	50	≥150	BEC
BC859C	225	100	30	420~800	BEC	BT5087	225	50	50	≥250	BEC
BC860A	225	100	45	110~220	BEC	BT8550B	225	800	25	85~160	BEC
BC860B	225	100	45	200~450	BEC	BT8550C	225	800	25	120~200	BEC
BC860C	225	100	45	420~800	BEC	BT8550D	225	800	25	160~300	BEC
BCW29	225	100	32	120~260	BEC	BTA70	225	100	40	40~400	BEC



NPN Silicon Amplifying Transistors

Type	P _{tot} (mW)	I _c (mA)	V _{CEO} (V)	h _{FE}	Polar 123
BC1622D6	225	100	35	200~400	BEC
BC1622D7	225	100	35	300~600	BEC
BC1623L3	225	100	50	60~90	BEC
BC1623L4	225	100	50	90~135	BEC

Type	P _{tot} (mW)	I _c (mA)	V _{CEO} (V)	h _{FE}	Polar 123
BC1623L5	225	100	50	135~200	BEC
BC1623L6	225	100	50	200~400	BEC
BC1623L7	225	100	50	400~600	BEC

PNP Silicon Amplifying Transistors

Type	P _{tot} (mW)	I _c (mA)	V _{CEO} (V)	h _{FE}	Polar 123
BA811C5	225	50	45	135~270	BEC
BA811C6	225	50	45	200~400	BEC

Type	P _{tot} (mW)	I _c (mA)	V _{CEO} (V)	h _{FE}	Polar 123
BA811C7	225	50	45	300~600	BEC
BA811C8	225	50	45	450~900	BEC

NPN Silicon Amplifying Transistors

Type	P _{tot} (mW)	I _c (mA)	V _{CEO} (V)	f _T (MHz)	Polar 123
2SC3356	225	100	12	7000	BEC
2SC3837K	225	50	18	600	BEC
2SC3838K	225	50	11	1400	BEC
BFR92	225	25	15	5000	BEC

Type	P _{tot} (mW)	I _c (mA)	V _{CEO} (V)	f _T (MHz)	Polar 123
BFR93	225	25	12	4500	BEC
BT918	225	50	15	600	BEC
BTH10	225	100	25	650	BEC
T9018	225	50	20	600	BEC

NPN Silicon High Voltage Transistors

Type	P _{tot} (mW)	I _c (mA)	V _{CEO} (V)	h _{FE}	Polar 123
BC1653N2	225	50	130	50~130	BEC
BC1653N3	225	50	130	100~220	BEC
BC1653N4	225	50	130	150~330	BEC
BC1654N5	225	50	160	50~130	BEC
BC1654N6	225	50	160	100~220	BEC

Type	P _{tot} (mW)	I _c (mA)	V _{CEO} (V)	h _{FE}	Polar 123
BC1654N7	225	50	160	150~330	BEC
BT5550	225	600	140	60~250	BEC
BT5551	225	600	160	80~250	BEC
BTA42	225	500	300	≥40	BEC
BTA43	225	500	200	≥40	BEC

PNP Silicon High Voltage Transistors

Type	P _{tot} (mW)	I _c (mA)	V _{CEO} (V)	h _{FE}	Polar 123
BT5401	225	500	150	60~240	BEC
BTA92	225	500	300	≥40	BEC

Type	P _{tot} (mW)	I _c (mA)	V _{CEO} (V)	h _{FE}	Polar 123
BTA93	225	500	200	≥40	BEC



NPN Silicon Switching Transistors

Type	P _{tot} (mW)	I _c (mA)	V _{CEO} (V)	h _{FE}	Polar 123
BT2369	225	200	15	≥20	BEC
BT2369A	225	200	15	≥20	BEC

PNP Silicon Switching Transistors

Type	P _{tot} (mW)	I _c (mA)	V _{CEO} (V)	h _{FE}	Polar 123
BT3640	225	80	12	30~120	BEC

NPN Silicon Driving Transistors

Type	P _{tot} (mW)	I _c (mA)	V _{CEO} (V)	h _{FE}	Polar 123
BTA05	225	500	60	≥100	BEC
BTA06	225	500	80	≥100	BEC

PNP Silicon Driving Transistors

Type	P _{tot} (mW)	I _c (mA)	V _{CEO} (V)	h _{FE}	Polar 123
BTA55	225	500	60	≥100	BEC
BTA56	225	500	80	≥100	BEC

NPN Silicon Darlington Transistors

Type	P _{tot} (mW)	I _c (mA)	V _{CEO} (V)	h _{FE}	Polar 123
BTA13	225	300	30	10000	BEC
BTA14	225	300	30	20000	BEC

PNP Silicon Darlington Transistors

Type	P _{tot} (mW)	I _c (mA)	V _{CEO} (V)	h _{FE}	Polar 123
BTA63	225	500	30	10000	BEC
BTA64	225	500	30	20000	BEC

Silicon Switching Diodes

Type	I _F (mA)	V _R (V)	t _{tr} (ns)	I _R (uA)	Polar 123
BAL74	200	50	4.0	0.1	
BAL99	100	70	6.0	2.5	
BAS16	200	75	6.0	1.0	
BAS19	200	100	50	0.1	
BAS20	200	150	50	0.1	
BAS21	200	200	50	0.1	
BAV70	200	70	6.0	5.0	
BAV74	200	50	4.0	0.1	
BAV99	150	70	6.0	2.5	

Type	I _F (mA)	V _R (V)	t _{tr} (ns)	I _R (uA)	Polar 123
BAW56	200	70	6.0		
BD2835	100	35	4.0		
BD2836	100	75	4.0		
BD2837	300	30	4.0		
BD2838	300	50	4.0		
BD6050	200	70	4.0		
BD6100	100	70	4.0		
BD7000	200	100	4.0		
BD914	200	70	4.0		

Silicon Schottky Diodes

Type	I _F (mA)	V _R (V)	t _{tr} (ns)	I _R (uA)	Polar 123
BAR43S	100	30	5.0	2.0	
BAT54	200	30	5.0	2.0	
BAT54A	200	30	5.0	2.0	

Type	I _F (mA)	V _R (V)	t _{tr} (ns)	I _R (uA)	Polar 123
BAT54C	200	30	5.0		
BAT54S	200	30	5.0		



Silicon Voltage Zener Diodes

Type	P _{tot} (mW)	V _Z (V)	r _Z (Ω)	I _R (uA)	Polar(123)
BZ5221B	225	2.4	30	100	+/-
BZ5222B	225	2.5	30	100	+/-
BZ5223B	225	2.7	30	75	+/-
BZ5224B	225	2.8	30	75	+/-
BZ5225B	225	3	29	50	+/-
BZ5226B	225	3.3	28	25	+/-
BZ5227B	225	3.6	24	15	+/-
BZ5228B	225	3.9	23	10	+/-
BZ5229B	225	4.3	22	5	+/-
BZ5230B	225	4.7	19	5	+/-
BZ5231B	225	5.1	17	5	+/-
BZ5232B	225	5.6	11	5	+/-
BZ5233B	225	6	7	5	+/-
BZ5234B	225	6.2	7	5	+/-
BZ5235B	225	6.8	5	3	+/-
BZ5236B	225	7.5	6	3	+/-
BZ5237B	225	8.2	8	3	+/-
BZ5238B	225	8.7	8	3	+/-
BZ5239B	225	9.1	10	3	+/-
BZ5240B	225	10	17	3	+/-
BZ5241B	225	11	22	2	+/-
BZ5242B	225	12	30	1	+/-
BZ5243B	225	13	13	0.5	+/-
BZ5244B	225	14	15	0.1	+/-
BZ5245B	225	15	16	0.1	+/-
BZ5246B	225	16	17	0.1	+/-
BZ5247B	225	17	19	0.1	+/-
BZ5248B	225	18	21	0.1	+/-
BZ5249B	225	19	23	0.1	+/-
BZ5250B	225	20	25	0.1	+/-
BZ5251B	225	22	29	0.1	+/-
BZ5252B	225	24	33	0.1	+/-
BZ5253B	225	25	35	0.1	+/-
BZ5254B	225	27	41	0.1	+/-
BZ5255B	225	28	44	0.1	+/-
BZ5256B	225	30	49	0.1	+/-
BZ5257B	225	33	58	0.1	+/-
BZ5258B	225	36	70	0.1	+/-
BZ5259B	225	39	80	0.1	+/-
BZ5260B	225	43	93	0.1	+/-

Type	P _{tot} (mW)	V _Z (V)	r _Z (Ω)	I _R (uA)	Polar(123)
BZ5261B	225	47	105	0.1	+/-
BZ5262B	225	51	125	0.1	+/-
BZ5263B	225	56	150	0.1	+/-
BZX84C2V4	225	2.4	100	50	+/-
BZX84C2V7	225	2.7	100	20	+/-
BZX84C3V0	225	3	95	10	+/-
BZX84C3V3	225	3.3	95	5	+/-
BZX84C3V6	225	3.6	90	5	+/-
BZX84C3V9	225	3.9	90	3	+/-
BZX84C4V3	225	4.3	90	3	+/-
BZX84C4V7	225	4.7	80	3	+/-
BZX84C5V1	225	5.1	60	2	+/-
BZX84C5V6	225	5.6	40	1	+/-
BZX84C6V2	225	6.2	10	3	+/-
BZX84C6V8	225	6.8	15	2	+/-
BZX84C7V5	225	7.5	15	1	+/-
BZX84C8V2	225	8.2	15	0.7	+/-
BZX84C9V1	225	9.1	15	0.5	+/-
BZX84C10	225	10	20	0.1	+/-
BZX84C11	225	11	20	0.1	+/-
BZX84C12	225	12	25	0.1	+/-
BZX84C13	225	13	30	0.1	+/-
BZX84C15	225	15	30	0.05	+/-
BZX84C16	225	16	40	0.05	+/-
BZX84C18	225	18	45	0.05	+/-
BZX84C20	225	20	55	0.05	+/-
BZX84C22	225	22	55	0.05	+/-
BZX84C24	225	24	70	0.05	+/-
BZX84C27	225	27	80	0.05	+/-
BZX84C30	225	30	80	0.05	+/-
BZX84C33	225	33	80	0.05	+/-
BZX84C36	225	36	90	0.05	+/-
BZX84C39	225	39	130	0.05	+/-
BZX84C43	225	43	150	0.05	+/-
BZX84C47	225	47	170	0.05	+/-
BZX84C51	225	51	180	0.05	+/-
BZX84C56	225	56	200	0.05	+/-
BZX84C62	225	62	215	0.05	+/-
BZX84C68	225	68	240	0.05	+/-
BZX84C75	225	75	255	0.05	+/-

Packing and Dimensions(mm)

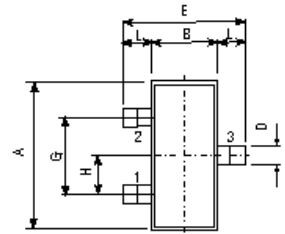
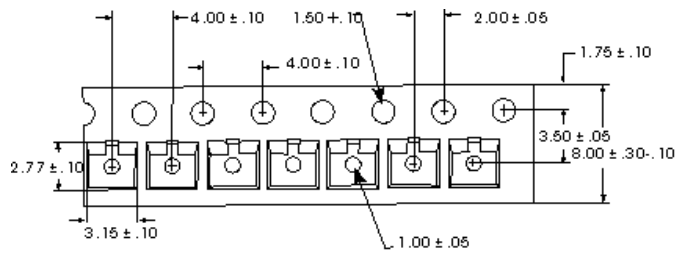

A	2.93 ± 0.20
B	1.30 + 0.20 / - 0.15
C	1.30 MAX
D	0.45 + 0.15 / - 0.05
E	2.40 + 0.30 / - 0.20
G	1.90
H	0.95
J	0.13 + 0.10 / - 0.05
K	0.00 - 0.10
L	0.55
M	0.20 MIN
N	1.00 + 0.20 / - 0.10
P	7

